



**Bem-vind@s**





Unidade de Serviços de Apoio às  
Atividades de Educação – **USAAE**

Unidade de Serviços dos Sistemas de  
Informação e Comunicações – **USSIC**



A USAAE é uma unidade que disponibiliza um conjunto de serviços de apoio ao ensino e aprendizagem

- Arqus Student Agora
- Plataforma de e-Learning
- Cursos a distância
- Laboratórios de informática
- Espaços pedagógicos e horários
- Formação pedagógica de docentes
- Inclusão, apoio a estudantes, docentes e outros trabalhadores com deficiência ou necessidades especiais

[suporte@usaae.uminho.pt](mailto:suporte@usaae.uminho.pt)



A USAAE possui instalações nos campi de Gualtar (Braga) e Azurém (Guimarães).

No **Campus de Gualtar** no **edifício 02** (CP2) e **edifício 01** (CP1).

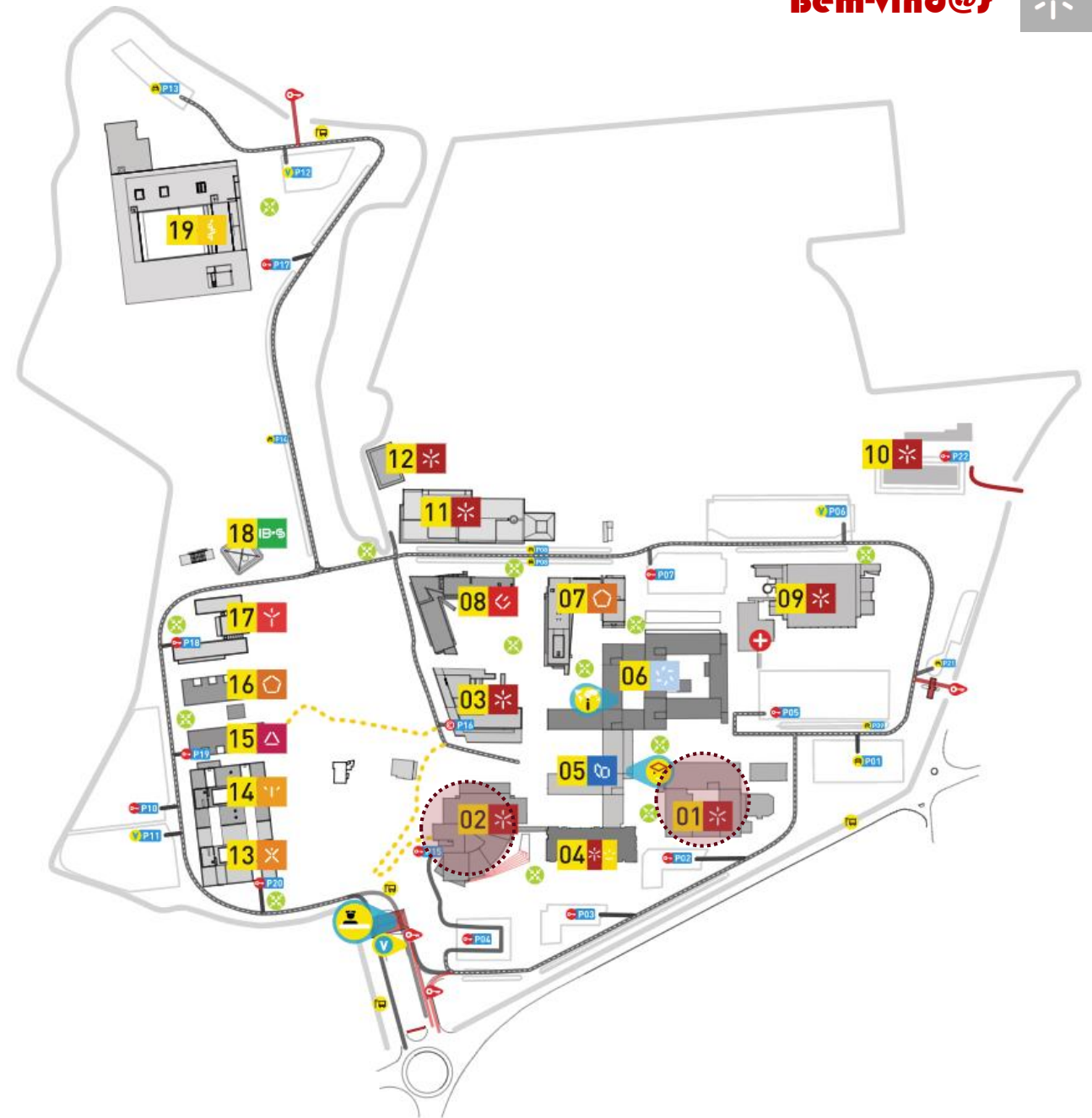



A USAAE possui instalações nos campi de Gualtar (Braga) e Azurém (Guimarães).

No **Campus de Azurém** no Bloco principal, edifício 01 e Escola de Ciências - edifício 12.

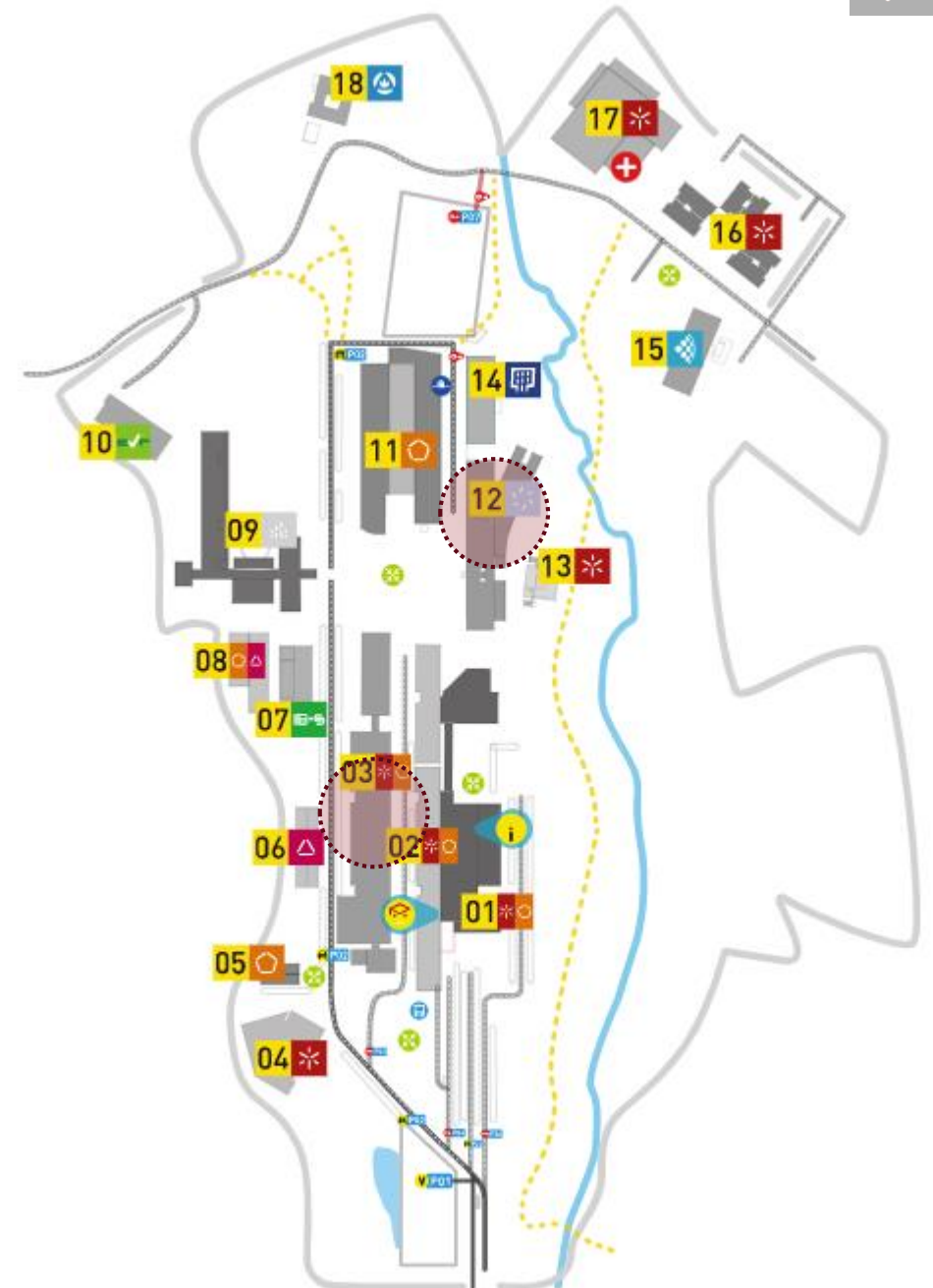



# Espaço virtual e e-Learning

The screenshot displays the login page of the Universidade do Minho e-learning system. At the top left, a language selection menu is open, showing options for English (United States), Español (España), Français (France), Nederlands (Nederland), Português (Portugal), Pro-Ed English (United States), 中文 (中國), and 日本語 (日本). The main header features the text "Universidade do Minho e-learning" with a plus sign. Below this, there are input fields for "NOME DE UTILIZADOR:" and "SENHA:", followed by a "Logon" button. On the right side, there are icons for home and back. At the bottom, a Blackboard logo and copyright information are visible.

Below the login page, the interface shows a course page for "Module 4 - The International Geosciences and Geoparks Programme of UNESCO". The left sidebar contains a navigation menu with the following items: Geoparks 3rd Edition, Module 0, Introduction, Learning Materials, Module 1, Module 2, Module 3, Module 4, Forum, Technical support, Messages, Achievements, and GMT+1 Time. The main content area is titled "Module 4 - The International Geosciences and Geoparks Programme of UNESCO" and features a video player showing a man speaking. To the right of the video, there are three expandable sections: "History and Evolution", "Programme", and "Applications", each with play and expand icons. Below these sections, there are three notification items: "Assignment | Submit Assignment - deadline 13th May 23:59 (GMT+1)", "Chat - 11th May - 14:00-15:00h (GMT+1)", and "Forum - Module 4". At the bottom of the page, there is a "COURSE MANAGEMENT" section with a "More" button and a calendar view.

# arQus

European University Alliance

## Some key numbers

+300 000  
students

+28 000  
professors

+19 000  
Administrative  
staff

+350  
Arqus  
personnel

+350  
Arqus  
mobilities



## ARQUS CAFÉ

<https://arqus-alliance.eu/action-lines/multilingualism/arqus-cafe/>



## STUDENTS UPDATES&CALLS

<https://arqus-alliance.eu/students/>

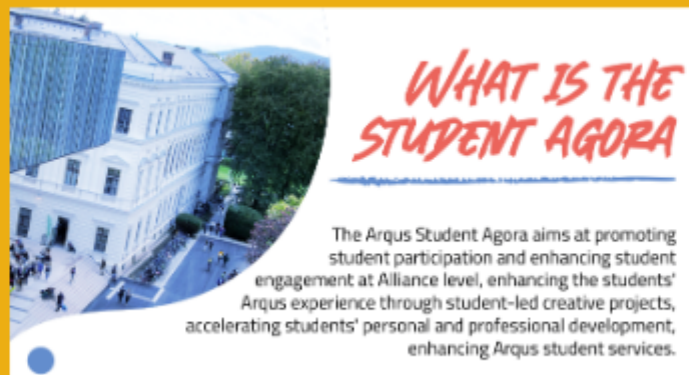

## ARQUS STUDENT AGORA

<https://arqus-alliance.eu/our-communities/arqus-student-agera/>



## IMPORTANT LAUNCHES

The Arqus Alumni Mentorship Programme is an online programme that connects Arqus alumni, regardless of their field of study or current profession, with current students and recent graduates to provide mentorship, career guidance, and networking opportunities.



The Arqus Alliance Ambassadors programme is an initiative led by the Arqus Student Agora and aims to create a network of student ambassadors of the Arqus Alliance member universities.







A USSIC é uma unidade que disponibiliza um conjunto de serviços de sistemas de Informação e Comunicações, entre os quais:

- Rede wi-fi
- Acesso VPN
- Email

[suporte@ussic.uminho.pt](mailto:suporte@ussic.uminho.pt)



A USSIC possui instalações nos campi de Gualtar (Braga) e Azurém (Guimarães).

No **Campus de Gualtar** no **edifício 06** e **edifício 04**.

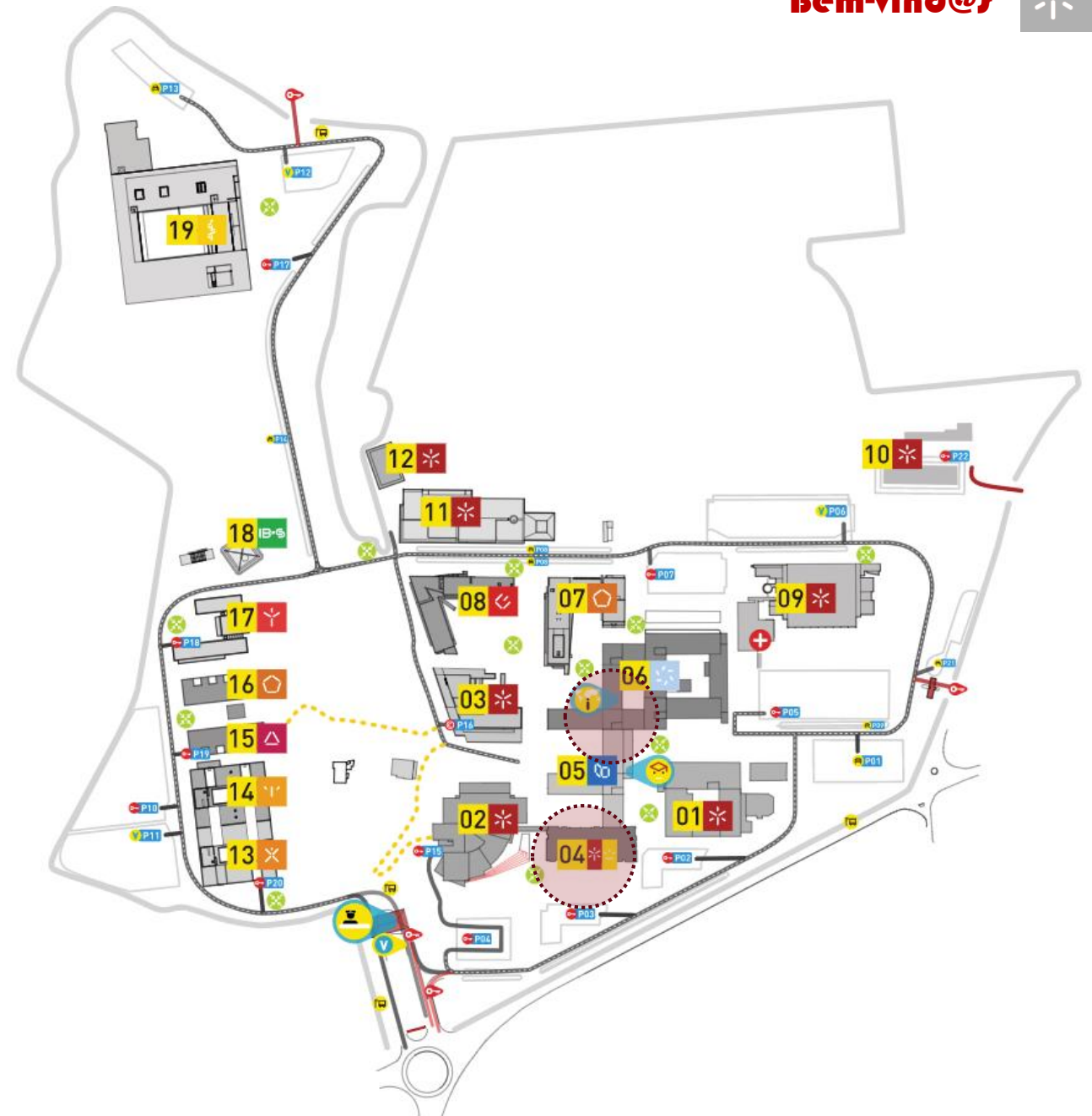



A USSIC possui instalações nos campi de Gualtar (Braga) e Azurém (Guimarães).

No **Campus de Azurém** no Bloco principal, edifício 01.

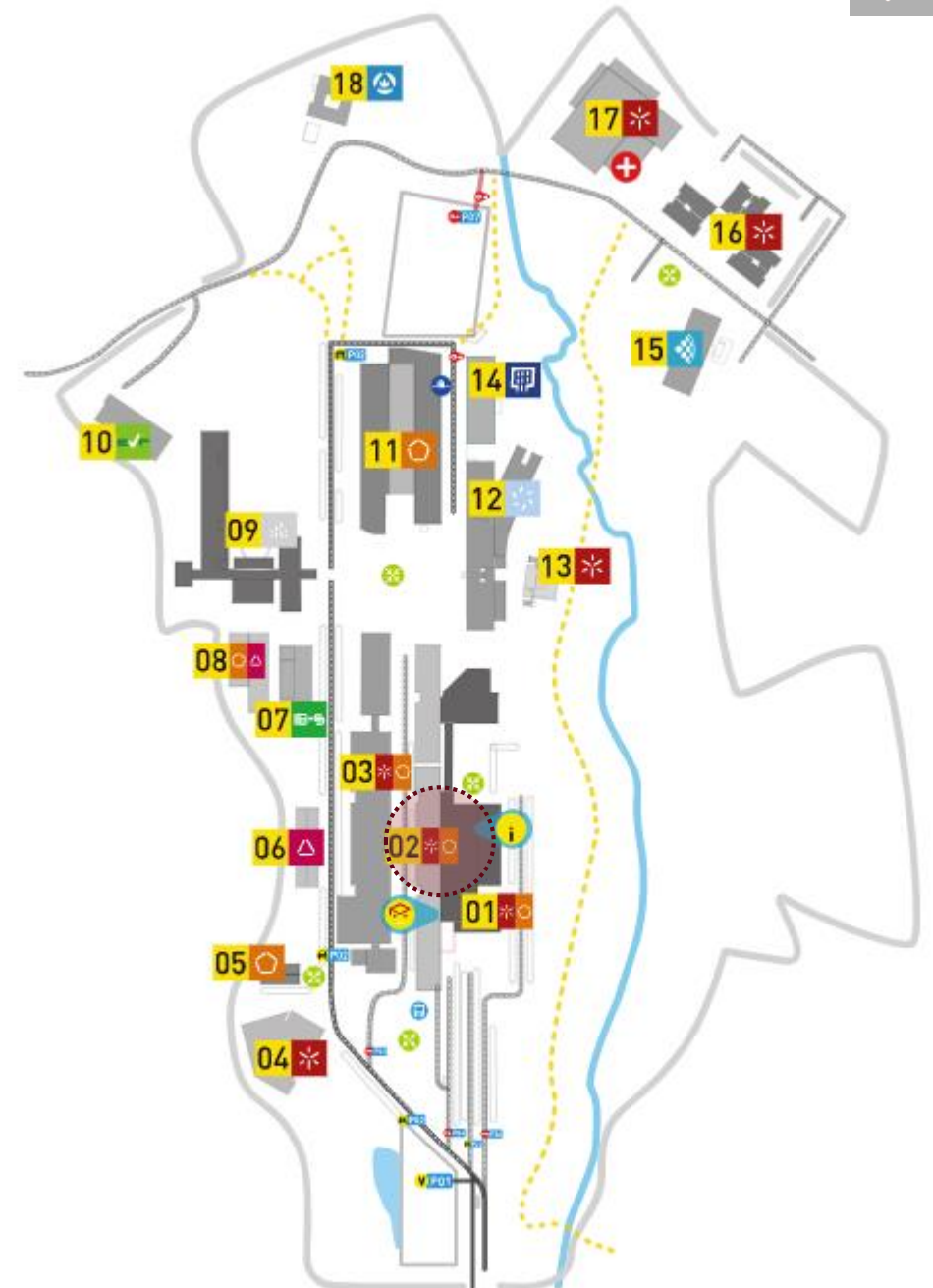



No **ServiceDesk** da USSIC podem obter apoio técnico na configuração de equipamentos para:

- Acesso à rede Wi-Fi Eduroam;
- Acesso remoto VPN.

Atendimento presencial (dias úteis): Braga e Guimarães

09:30 AM – 12:00 PM

Contatos do serviço:

Email: [servicedesk@ussic.uminho.pt](mailto:servicedesk@ussic.uminho.pt)

Telefone: 253 601000

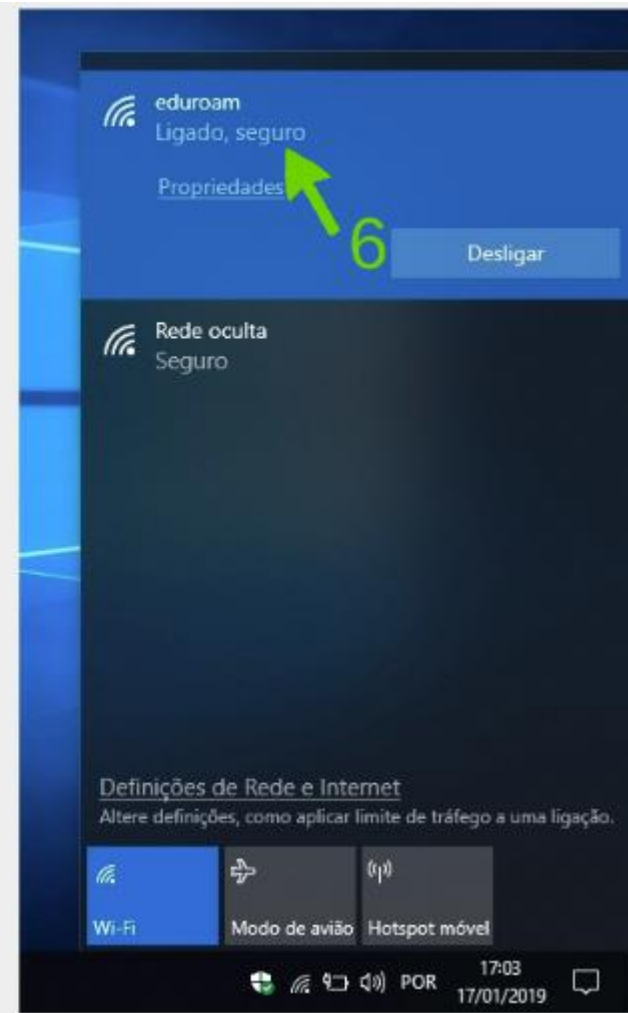
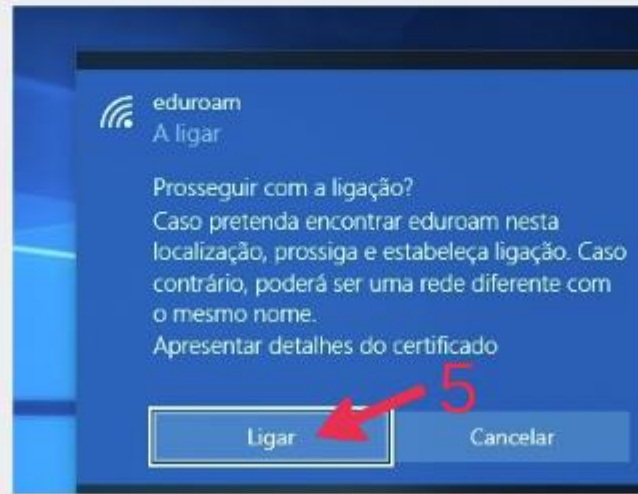
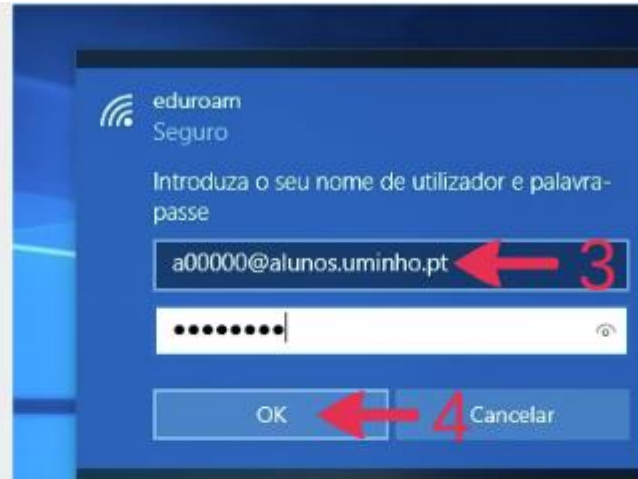
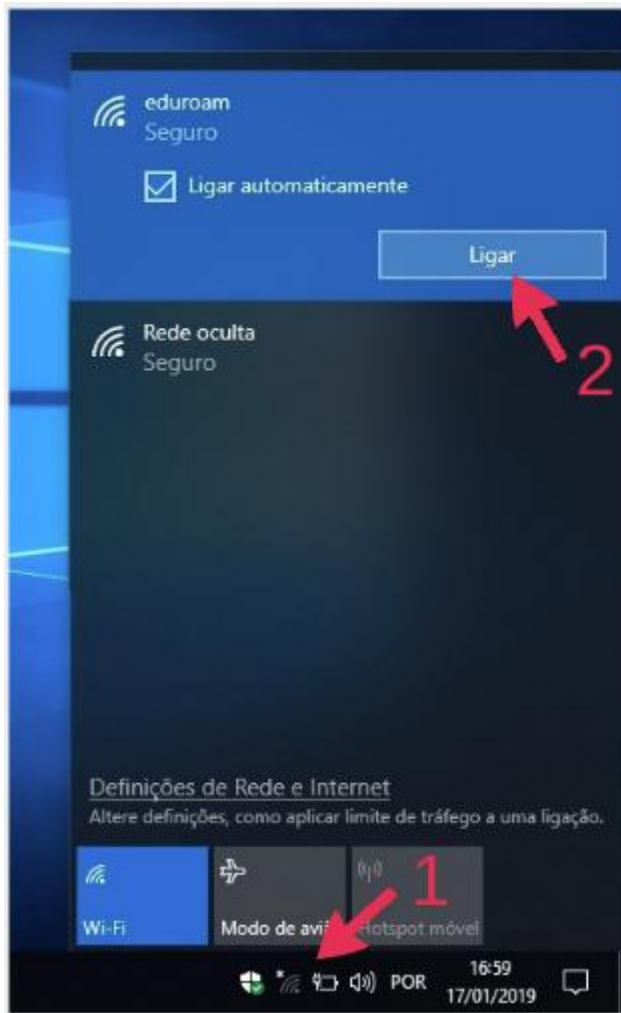

A close-up photograph of a vintage typewriter. A sheet of white paper is inserted into the carriage, and the words "Send a Mail" are printed in a black, monospaced font. The typewriter's keyboard, with black keys and white lettering, is visible in the lower portion of the frame. The machine is a dark green color.

Send a Mail

A Universidade do Minho disponibiliza aos seus alunos o serviço de email, com uma caixa de email, com proteção anti-spam /anti-vírus com armazenamento de 50GB, integrada no Office365.

No âmbito de um acordo entre a UMinho e a Microsoft, os alunos inscritos podem efetuar o download sem custos das ultimas versões do Office acedendo à caixa de email institucional, do tipo: [e547@alunos.uminho.pt](mailto:e547@alunos.uminho.pt)

[suporte@ussic.uminho.pt](mailto:suporte@ussic.uminho.pt)



Software

- Office
- Tools & add-ins
- Skype for Business
- Phone & tablet

Office

Manage installs

Want to deactivate Office on one computer and install it on another? Go to [My account > Install status](#).

Install Office 365 ProPlus with the new 2016 apps [What happened to Office 2013?](#)

Note: Your admin has enabled First Release, so you get early access to the latest Office features. If you have feedback or problems, please contact your admin.

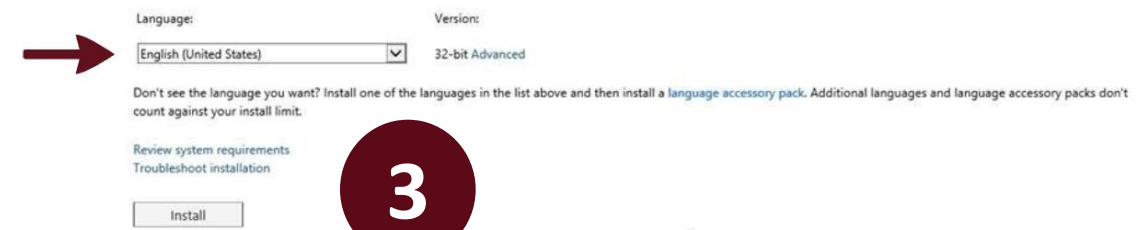

# Office 365



Modificação de password: <http://alunos.uminho.pt>



Acesso ao email: <http://mail.alunos.uminho.pt>



Plataforma de eLearning: <http://elearning.uminho.pt>



Wi-Fi Eduroam e VPN: <http://www.scom.uminho.pt>



**Obrigado !**



GOOD  
VIBES  
ONLY